

Brompton folding bike spare parts listing

Please take care when ordering your parts.

<u>Description</u>	<u>Section</u>	<u>Description</u>	<u>Section</u>
Brakes and brake cables	B	Mudguards, stays and fittings	M
Carrier system and cloth items	C	Sundry parts Grips, saddle, pump, bell, decal etc	S
Frame, joints and other "structural" bits	F		
Frame parts	F1	Transmission	T
Headset	F2	Pedals	T1
Seat pillars and Handlebar	F3	Chainsets	T2
Rollers	F4	Bottom bracket cartridges	T3
Rear Carrier Bits	F5	Chain	T4
"Folding" detail, joints, frame, etc.	F6	Chain tensioner	T5
		Rear sprockets and spacers	T6
Hubs, gears, derailleur, and controls	H		
Axle bits, hubs & gear-internals, dynohub	H1	Wheels, tyres and wheel parts	W
Controls and cabling, hub gears	H2	Wheels	W1
Control, cabling & actuator, derailleur	H3	Tyres	W2
		Rims and spokes	W3
Lights and fittings	L		
Battery powered	L1		
Dynamo powered	L2		
Reflectors	L3		

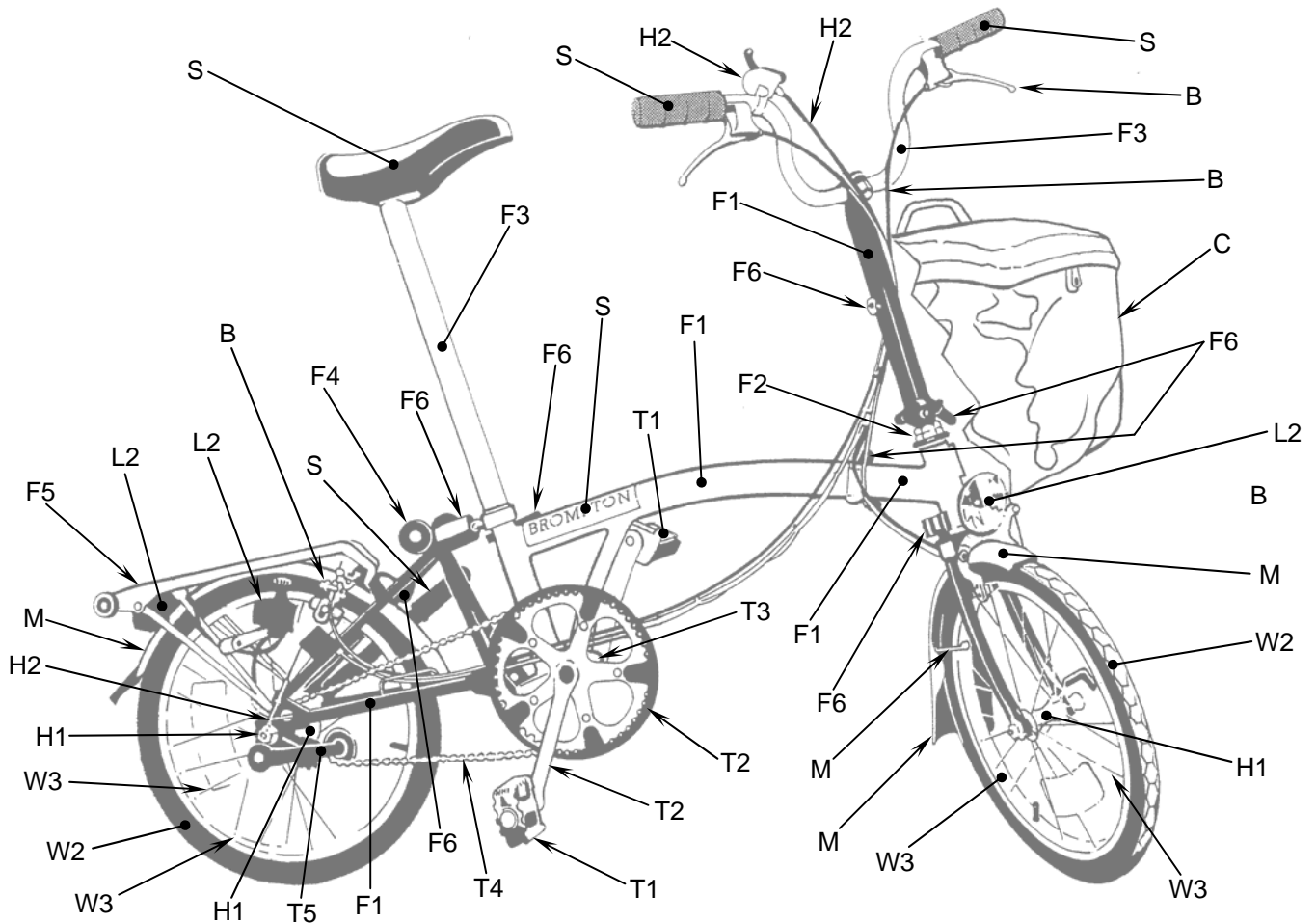

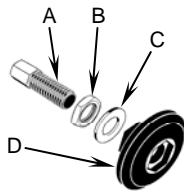

Lower stop disc (Section F6):

A + B + C + D = QLSDA (mk 3)

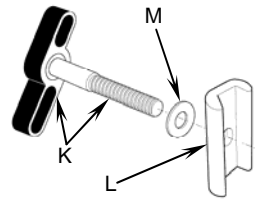

Hinge clamp (Section F6)

K + L + M = QHCA

K = QHCLEVA

L = QHCPL

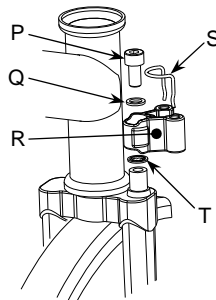

Handlebar catch (Sec F6):

P to T + nipple (not shown) = QHBCA

S (10 pieces) = QHBCSPRING10

Rollers (Section F4)

U = QROLM

V = QROLMBOLTS (screw, washer & spacer)

Z (forward roller) = QEZWOLF-6

Suspension block (Sec F6):

A to E = QSUSPBA

C (6 pieces) = QSUSPBUSH

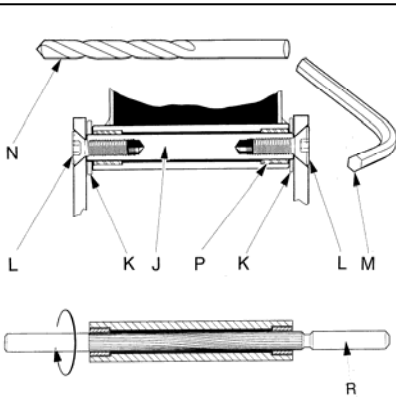
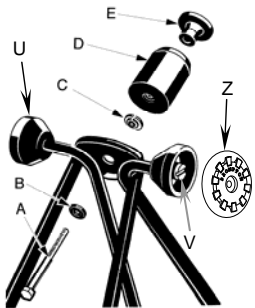

Rear hinge (Section F6):

Note: if new hinge bushes need to be fitted, they must be reamed in situ after pressing fitting, and a special reamer with pilot is available for this.

J to P = QRHBKIT (inc. bushes)

J to N = QRHKIT (exc. bushes)

J + L = QRHSPIN

R = QRHREAM

Telescopic seat pillar spares

(Section F3):

A + B + C = QSPTK

D + E = QSPTCQR

E = QSPTQR

G + F = QSPTS

G (titanium) + F = QSPTSTI

H = QSPTTOP

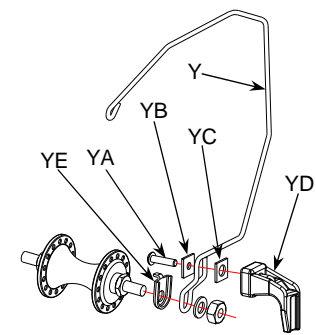
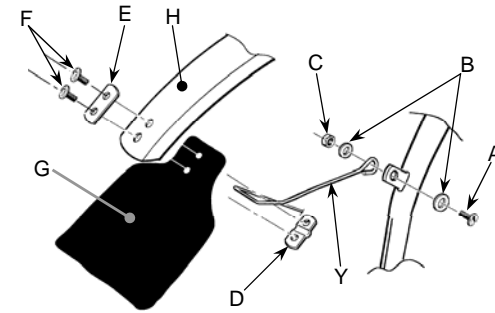
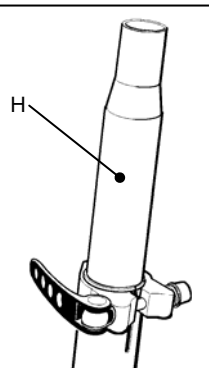
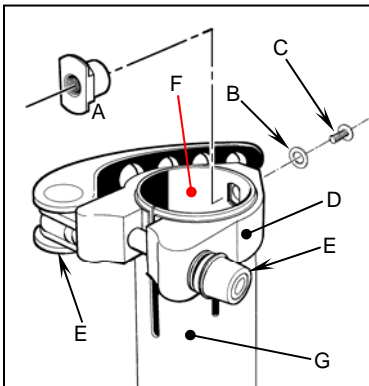

MUDGUARDS & STAYS (section M):

A to Z + YA to YE = QMGSETL (complete mudguard set for an E-version using steel stays)

A to Z + YA to YE = QMGSETL-TI (ditto, titanium stays)

A to M + YF to YH + O to Z = QMGSETL-DYN (for an E-version with dynamo, using steel stays)

A to M + YF to YH + O to Z = QMGSETL-TI-DYN (ditto, titanium stays (item YH steel))

H + D to G = QMGF

G = QMGFLAPF

Z + J to M = QMGRLA

ZZ + J to M = QMGRRA (with cut-out for dynamo)

ZZ + J to M = QMGRRA (without cut-out for dynamo)

J to M = QMGFLAPR

T to X = QMGROLA

Stays etc:-

Y + A to F + YA to YE = QMGSAFA (steel stay)

Y + A to F + YA to YE = QMGSAFA-TI (titanium stay)

YA to YD + wire-form (not shown) = QHOOKWFA-E (for E-version, no mudguards)

YA to YD = QHOOKA

Y + A to F = QMGSAFA (for 5-spd with integral wire hook)

PVC sleeve for above item (not shown) = QMGSAFA-SLV-01

N to S = QMGRSET (steel stays)

N to S = QMGRSET-TI (titanium stays)

YH = QVMGRDYN

YF + YG + E + F + K + M = QMGRD-STAP-KIT

D to F = QMGSTAP

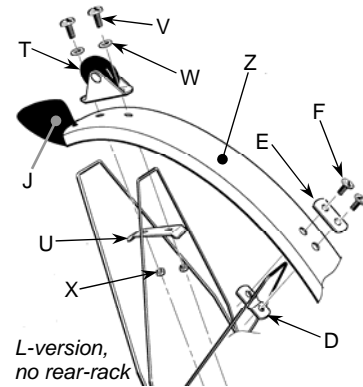

L-version, no rear-rack

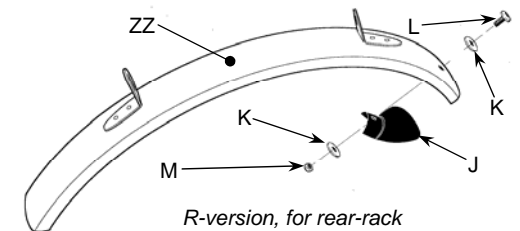
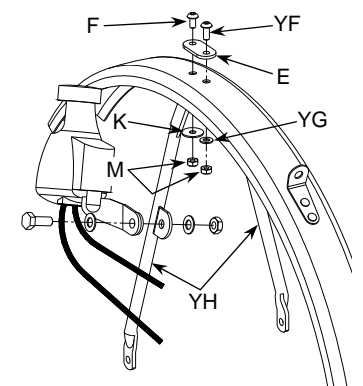
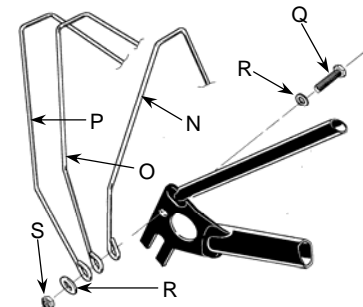

R-version, for rear-rack

Dynamo lighting (Section L2):

Complete sets:

The rear lamp includes a capacitor and stays on when the bike is stopped. For complete sets, the front halogen lamp includes a reflector.

F to K + P to S + T + U + cable-ties = QVDYNOSET-E

G to S + cable-ties = QVDYNOSET-L

A to K + cable-ties = QVDYNOSET-R

H to J + P to R + V to X + cable-ties = QVHUBDYNSET

Sundries:

G + S + tie-wraps = QVDWLOOM-NR

G + C + tie-wraps = QVDWLOOM-R

I + tie-wraps = QVDWLOOMHDYN

BB = QVBULBFH

BB (non-halogen, not shown) = QVBULBFI

ZB = QVBULBR

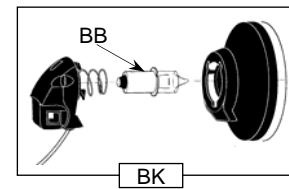
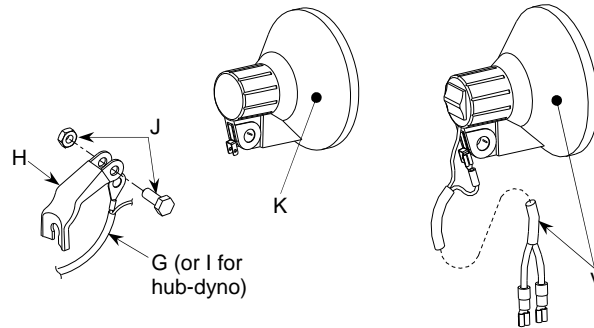

Front lamps & bracket:

BK (compact) = QVDYNFLAMH

K (with reflector) = QVDYNFLAMHR

V (switched) = QVDYNFLAMH-SW

K (non-halogen) = QVDYNFLAMI

H + J = QVBKTFLAMHDYN

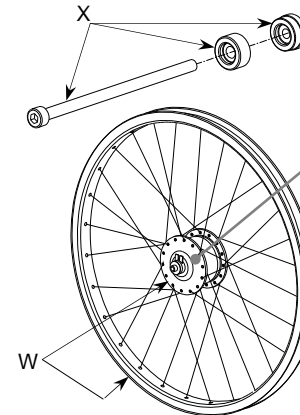

Dynamos and fixings:

N = QVDYNO-LH

F = QVDYNO-RH

W = QFWHUBDYNSS

Y = QHUBFDYN

T + U = QVBKTDYN-E

L = QVMGSRDYN

D = QVRCSTDYN

BD = QVRCSTDYNL

X = QFWHUBDYN-NB (Section H1)

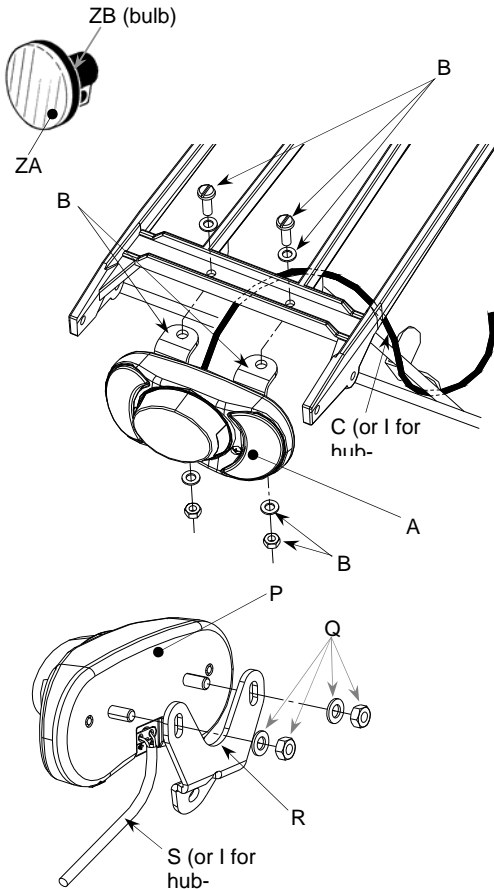
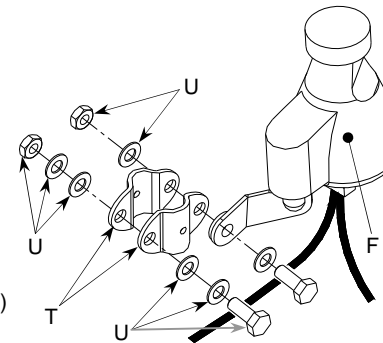

Rear lamps:

A or P = QVDYNRLAMCAP

ZA = QVDYNRLAMO

R = QVBKTRLAM-NR

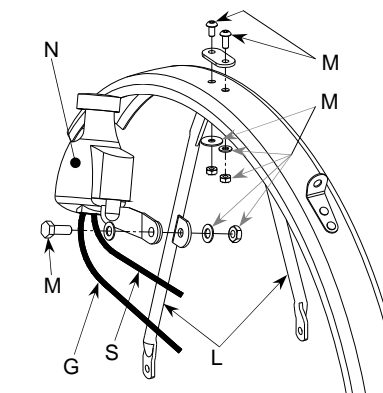
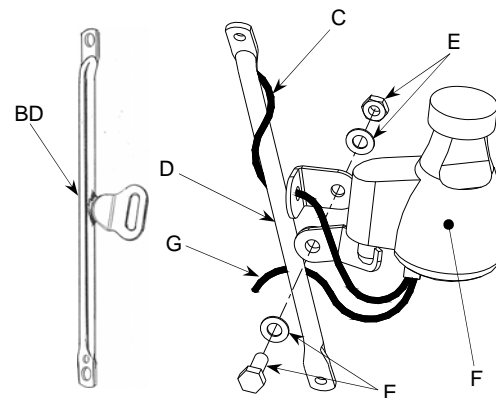

Battery lighting (Section L1):

Batteries included with lamps.

Items A-D only required on M-type, items H are not required and are shown to identify where items K are used and item J is only needed on L- or E-version.

Complete set, for any model:

A to G + J to K = QVBATLAMSET

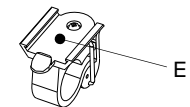
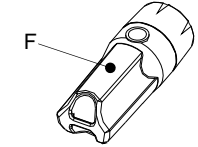

E + F = QVBATFLAM

A to D = QVBKTFLAMBAT

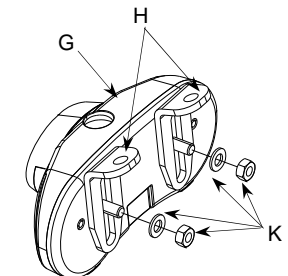
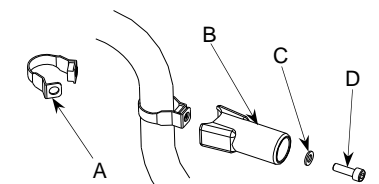

G = QVBATRLAM

G + K = QVBATRLAMA-R

G + J + K = QVBATRLAMA-NR

J = QVBKTRLAM-NR

